

CoreSync Wireless PoE Gateway

molex

The CoreSync Wireless PoE Gateway enables remote network control of lights, sensors, local dimmers and zone controllers.

The CoreSync PoE Gateway enables the integration of EnOcean based devices to be integrated for monitoring and control in the CoreSync system. The Gateway is powered and IP connected via CAT5e or CAT6 UTP cable to the Network Equipment and the CoreSync Manager. The gateway can connect and control up to 20 devices. EnOcean standard based wireless communication is robust and reliable. The gateway has a typical range of 50' (max. 80') and can cover an area of 1000 square feet.



Features and Benefits

PoE-powered and controlled, using standard Category cables

Eliminates need for a local power supply and/or AC line connection

Individual Gateway effective range: 50' (15m) range

Each Gateway enables extensive CoreSync system coverage

Non-discoverable 2-way communication, using rolling code and 128 AES encryption

Highly reliable and secure communications for control/status of multiple wireless devices; no interference with other wireless networks

Compatible with CoreSync self-powered wireless zone modules, dimmers, sensors, wall switches, etc.

Flexible remote and local control; real-time status reporting in buildings, zones or individual fixtures; ability to control AC loads

CoAP based IP communication with CoreSync Manager

Helps create unique scenes and biorhythmic lighting sequences

Compact size and mounting dimensions

Enables ease of mounting

UL60950-1, CE, FCC

Safe operation and industry-standard compliance

Lighting grade white paint coating

Attractive, durable finish and look

Power over Ethernet (PoE) Ready

The CoreSync Wireless PoE Gateway is ready for fast, easy connectivity thanks to the RJ45 interface, compatible with standard CAT5e or CAT6 UTP cables.



Wireless PoE Gateway



Compatibility / Capabilities

Wireless PoE Gateway
180993-3001 (NA)
180993-3002 (EUR)



High Wattage/ Line Voltage	Wireless Zone Control Module Series 180997	Wireless Ambient Light Sensor Series 180997	Wireless Occupancy Sensors Series 180997	Wireless Wall Switches Series 180997

PoE Gateway in the CoreSync Control Architecture

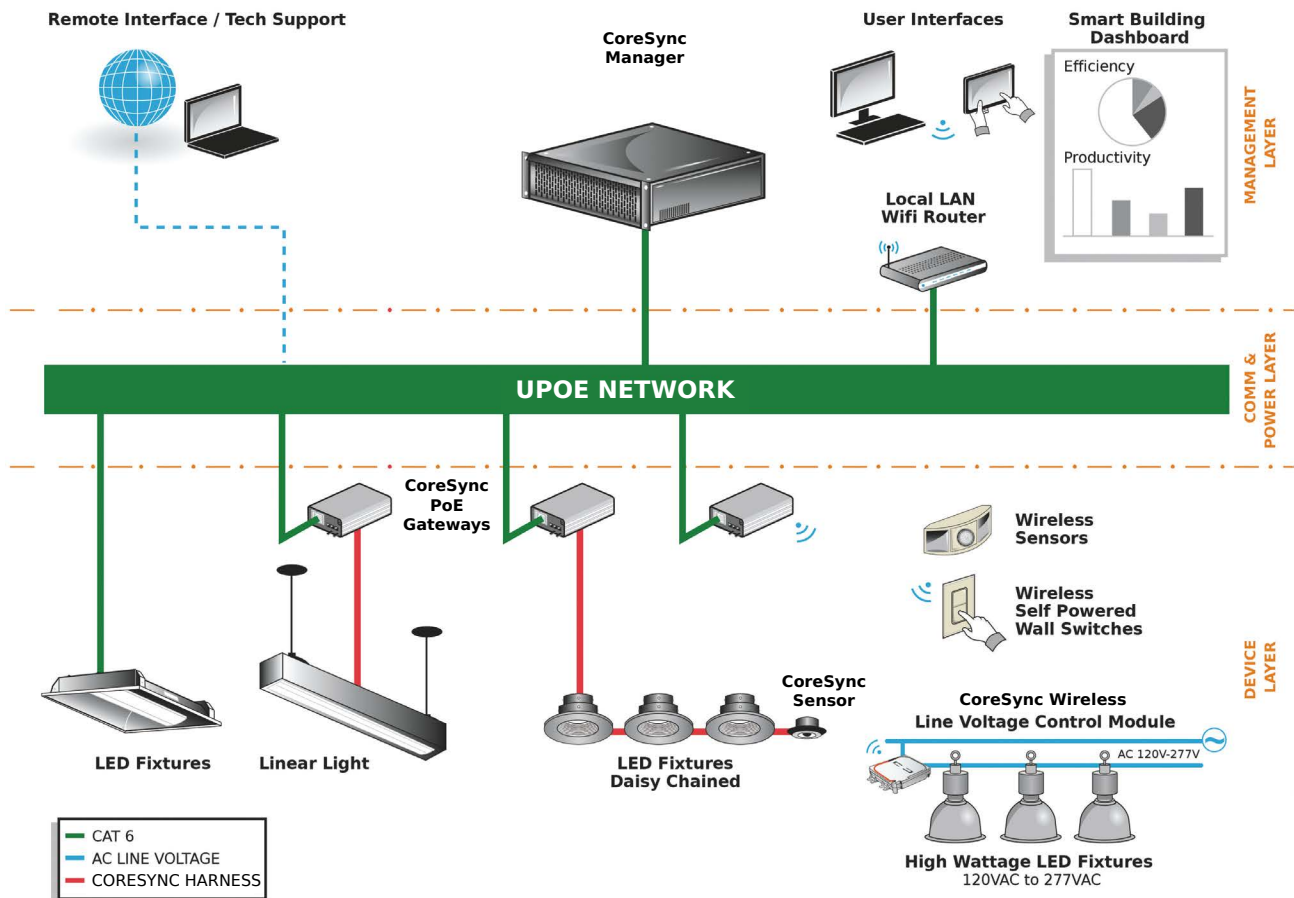

Wireless PoE Gateway



Specifications

ELECTRICAL

PoE, PoE+, UPOE, IEEE 802.3bt
 Standby Power Consumption 0.5W
 Nominal Power Consumption 2.0W
 Class II Electrical Device: UL60950-1

ENVIRONMENTAL

Operating Temperature: 0° to 40°C
 Relative Humidity: 10-80% Non-Condensing
 Environmental Rating: Indoor

MECHANICAL

Housing Material: Extruded Aluminum
 Length: 119.65 mm
 Width: 53.33 mm
 Depth: 25.51
 Weight: 113g

Dimensions

Part Number	DIM "A"
180993-3001	50.8mm / 2.0"
180993-3002	69.8mm / 2.75"

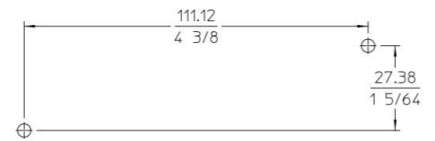
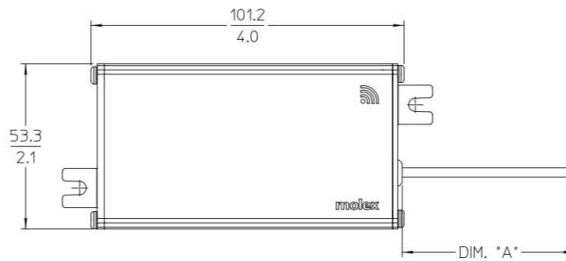
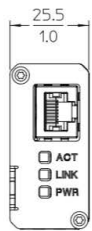

MOUNTING HOLE LOCATION
 HOLES FOR AN #8-32 SELF TAPPING SCREW



Ordering Information

Order Number	Description
180993-3001	CoreSync Wireless PoE Gateway, 902MHz, N. America
180993-3002	CoreSync Wireless PoE Gateway, 868MHz, Europe

www.CoreSync.molex.com

Molex is a registered trademark of Molex, LLC in the United States of America and may be registered in other countries; all other trademarks listed herein belong to their respective owners.