



REHAU SMART GUARD OPERATING INSTRUCTIONS



718653 DE_en
Subject to technical changes
www.rehau.com

Construction
Automotive
Industry

Technical data

| | |
|----------------------------------|---|
| Description | REHAU SMART GUARD |
| Window systems | SYNEGO®, GENE0® |
| Electricity supply | 2 x 1.5 V Mignon/LR6/AA |
| Battery life | about 2 years |
| Dimensions L x W | 220 mm x 52 mm (SYNEGO) 220 mm x 54 mm (GENEO) |
| Signal generator sound intensity | 60 dB(A) |
| Wireless frequency band | 868 MHz |
| Wireless standard | EnOcean (www.enocean.com) |
| Type of protection | IP 54 |
| Temperature range | From -20 °C to +60 °C |
| Housing material | PA12 |

Important information

Instructions on usage

Thank you for choosing a REHAU SMART GUARD product.
To prolong the enjoyment of your REHAU SMART GUARD, we ask you to carefully read and observe the instructions given in this manual.

These operating instructions form part of the REHAU SMART GUARD and must be available at all times. They should be made available to all service technicians carrying out maintenance work and made available to new tenants or owners.

This device can be used by adolescents from 16 years, and persons with reduced physical, sensory or mental capabilities or lack of experience and knowledge if they are supervised or have been trained in the safe use of the device and they understand the potential risks. Children are not permitted to play with the device. Cleaning and user maintenance is not permitted to be performed by children.

If you have not understood the safety notes as well as the individual operating steps or they are unclear, contact us on:
Phone: 09131/92-5226

Pictograms and logos



Safety warnings



Legal information



Important information

Product description

Main unit

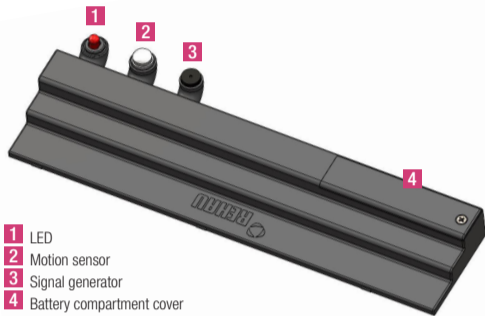

Cover



Magnet



System setup

REHAU SMART GUARD operating modes

The REHAU SMART GUARD can be used in two operating modes:

1. Stand-alone (without a central unit)

Preventative alarm and alarm only via the SMART GUARD on the window, operated via the window sash. Activation by the open-close-open motion of the window sash plus confirmation sound. Deactivation by opening the window from the inside. If the deactivation triggers an alarm, then a preventative alarm has already been triggered by a sensor. This returns to the original state after sounding an alarm for 30 seconds.

A stand-alone system can be upgraded to an alarm or Smart Home system as follows:

- Remove the batteries from the SMART GUARD
- Open and close the window sash three times

The SMART GUARD has been reset to its factory settings and can be paired with the Indoor Siren plus system or the Mediola box.

2. Alarm system or Smart Home (with a central unit)

Version 1 – Alarm system SMART GUARD plus system, central unit: Indoor Siren SMART GUARD plus system

The indoor sirens are, as described in the operating instructions for indoor sirens, configured within 20 seconds of a battery being installed. If the SMART GUARD is not paired with indoor sirens within 20 seconds, then the stand-alone mode is activated.

Version 2 – Smart Home system SMART GUARD connect system, central unit: Mediola box

The Mediola box is, as described in the Commissioning Smart Home section, configured using the REHAU SMART app within 20 seconds of a battery being installed. If the SMART GUARD does not pair with the Mediola box within 20 seconds, then the stand-alone mode is activated.

System setup



The magnet cannot be placed on the REHAU SMART GUARD casing during the commissioning in stand-alone mode or configuration of a central unit.

Compatibility with gateways

A Smart Home central unit with an EnOcean wireless flash drive is needed to use the REHAU SMART GUARD connect system.

You can find out which gateways can be used with the REHAU SMART GUARD connect system by scanning the QR code below to access the relevant website.



You will also need the free REHAU Smart app to control the central unit. You can download this from the usual app stores.

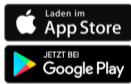

Troubleshooting

| Problem | Cause | Solution |
|---|--|---|
| REHAU SMART GUARD not found by the app | No wireless signal, wireless path too long | Use a repeater |
| | Empty battery | Replace batteries |
| No alarm | Alarm status is inactive | Test for function with alarm on |
| Not working after battery insulation tab has been removed | Empty battery | Replace batteries |
| Not working after batteries have been replaced | Empty battery | Replace batteries |
| | Internal error | Call our hotline |
| Alarm constantly triggered | Missing or out-of-place magnet | Reposition the magnet and secure into place |

Service

Service

If the SMART GUARD does not work or you need help with another problem, please contact the REHAU service hotline at:

Phone: 09131/92-5226
Email: service.smartguard@rehau.com



Disposal



The unit conforms to EU Directive 2011/65/EU on restricting the use of certain hazardous substances in electrical and electronic equipment.

The REHAU SMART GUARD and the batteries may not be disposed of in the household waste. Dispose of the device and batteries separately.

The REHAU SMART GUARD is registered in the National Register for Waste Electrical Equipment ("EAR"). Collection points for electronics recycling take back the electronic components of REHAU SMART GUARD free of charge.

Dispose of used batteries at your local disposal centre. The local and country-specific regulations for disposal must be observed.

Important information

Intended use

The REHAU SMART GUARD is an alarm system intended to be a permanent installation in the REHAU SYNEGO and REHAU GENE0 systems.
It may only be installed on the upper horizontal window frame profile.
Changes and modifications to the device are not permitted.
The operational reliability of the device is only guaranteed if used properly.
Please observe the instructions in these operating instructions.



We accept no liability for improper use or modifications to the product and all resultant consequences.

Safety notes

Handling batteries



- Store protected from humidity
- Keep out of reach of children
- Do not heat over 100 °C or set on fire
- Do not short-circuit
- Do not open or damage
- Do not recharge

Installation (specialist window fitter only)

Installation

Step 1:

- Mark the installation positions for the REHAU SMART GUARD on the upper part of the window frame.

Step 2:

- Remove the centre seal and the centre seal bar, if necessary (only for MD systems).

Step 3:

- Clamp the drilling jig, art. no. 1326575. Make sure that the drilling jig is positioned flush to the window frame and is clamped securely.

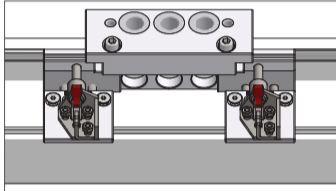

Step 4:

- Drill the holes in the window frame using the appropriate drill bit. Clean up the shavings after drilling.

Step 5:

- Clip in the REHAU SMART GUARD module.

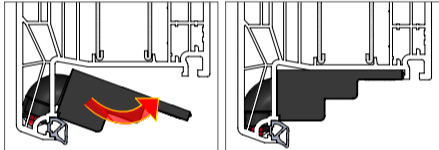

Safety notes

Installation



Installation, commissioning and maintenance work is only permitted to be carried out by people with adequate qualifications. At the same time, local/regional and country-specific regulations regarding accident prevention regulations, applicable standards, guidelines and regulations must be observed.
Opening the device and the accessories, with the exception of the battery compartment cover, is generally prohibited.

Modifications to the device



Modifications to the device may compromise the safety and function of the device and the entire system.

- Unauthorised conversions and changes to the device are not permitted.
- Changes to the construction may impair the functions and operational safety and are generally prohibited.
- Equipment parts and accessories that are not in perfect condition must be turned off by removing the battery and replaced immediately.
- Use only genuine spare parts and accessories from the manufacturer.
- The factory labelling on the device may not be changed, removed or made illegible.

Installation (specialist window fitter only)

Step 6:

- Unclick the frame on the external side of the window frame.

Step 7:

- Position the magnet in the upper sash groove and screw in using the screws containing in the delivery (ISO 7049 – Ø 2.2 x 16).

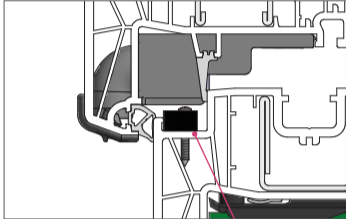

Positioning the window magnets in the middle of the marks on the casing.

Changing the batteries

Changing the batteries

The batteries in the REHAU SMART GUARD have a battery life of about two years. The REHAU Smart app has instructions on how to change the battery depending on the device.

The absence of a confirmation sound on activation in stand-alone mode indicates that the batteries need to be replaced.

To change the batteries, unscrew the battery compartment cover and remove the cover. Remove the old batteries, open and close the window sash three times, insert two new 1.5 V Mignon/LR6/AA batteries. Make sure that the polarities are correct when inserting new batteries.

After they have been replaced, replace the cover and screw into place. When replacing the cover, make sure that the seal is in the correct position. You do not need to pair the REHAU SMART GUARD again. However, the device needs 25 seconds to reactivate after the batteries have been changed.



Attention!

Danger of explosion if the wrong type of battery is used. The REHAU SMART GUARD may only be used with 1.5 V Mignon/LR6/AA batteries.

Maintenance

Maintenance

The REHAU SMART GUARD does not need maintenance.

Insofar as the intended application deviates from that described in the valid operating instructions, the user must consult REHAU and must receive express written consent from REHAU before commencing this utilisation. If the user fails to do so, the sole responsibility for the utilisation shall lie with the individual user. Any application, utilisation and processing of the products shall, in this case, be beyond our control.

This document is protected by copyright. The rights established therein, in particular for translation, reprint, extraction of illustrations, radio transmission, reproduction by photomechanical or comparable means and the storage in data processing systems, are reserved.

Version 3 - 09/2018