



SecuSignal – shows you
what you should know
about your windows!

Welcome to the assured world of SecuSignal ...



Does the following situation sound familiar to you?

Monday morning - you leave home in a hurry. Just as you've closed the door you begin to wonder, "Did I close all the windows in case it rains? Did I remember to close the French doors to the patio last night or are they only tilted – an open invitation to intruders?"

In order to be sure, the only thing to do is to open the door, go back inside and check each window upstairs and downstairs to make sure you haven't forgotten one ...

Wouldn't it be more assuring if, before you left the house, you could check at a glance whether all windows were closed or not? SecuSignal, HOPPE's new window handle generation with **integrated cable and radio technology - without the need for batteries** - can offer you just that!

On the following pages you can find out about SecuSignal in detail. You'll see how easy it is to be sure whether your windows are fully closed or not so you can be assured on leaving home.



SecuSignal



What does SecuSignal offer?



HOPPE brand quality, simple installation and no maintenance.

The SecuSignal system consists of at least one SecuSignal window handle with a radio emitter - without the need for batteries - and a SecuSignal receiver. As with all HOPPE's door and window handles, this brand name product also comes with a 10-year operational guarantee.

Changing your old window handles or the new SecuSignal window handles is very easy and only takes a few minutes.

- ① Turn the old window handle into the opening position (horizontal). Slightly lift the cover cap and turn it to the side. Then loosen the screws and remove the old handle.
- ② Now you can fit the new SecuSignal window handle with its radio emitter. Simply insert the solid spindle of the handle into the spindle hole of the window. In so doing the window handle remains in the closed position (vertical).
- ③ Turn the SecuSignal window handle to the opening position (horizontal). Lightly lift the cover cap and turn it to the side and then simply attach the window handle and radio emitter with the screws provided.
- ④ All you need to do now is turn the window handle and cover cap to the vertical position and the job is done!

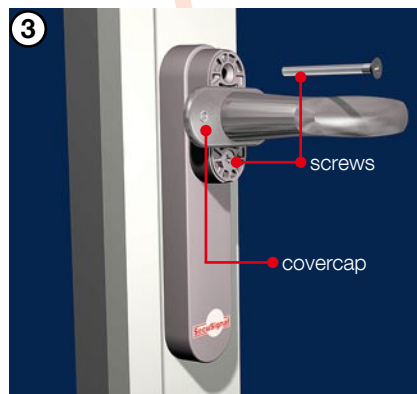
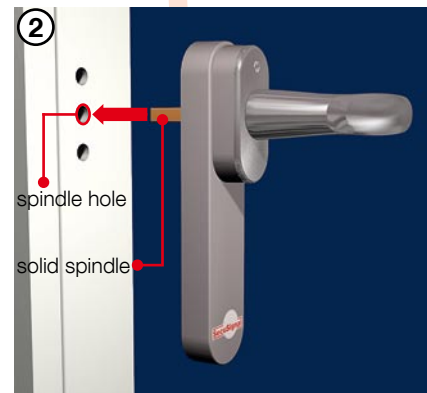
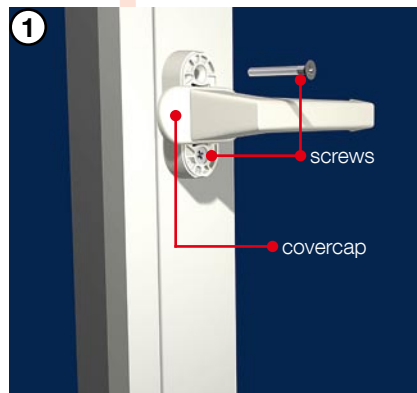

Once the receiver has been connected to the mains (220 v) and the window handle has been set, the emitter sends information about the position of the window handle - and the window handle itself, directly to the receiver unit. Here this information is shown by coloured lights with an indication of the room concerned in a two digit display and stored (see pp 6 and 7). In such a way you can check at a glance whether your windows are open or not at anytime.

**The SecuSignal emitter needs
neither wiring nor batteries.**

In turning the SecuSignal window handle, energy is produced by a patented system*, so no tiresome checking or changing of batteries is necessary and no batteries need to be disposed of either, preventing further harm to the environment. The, the SecuSignal radio emitter is totally maintenance-free.

To ensure a high assurance of transmission, the radio signal is sent out many times in short succession at just one turn of the handle. Depending on the type of building, range is about 30 m. With its advanced technology, SecuSignal works with minimal transmitter power, so any electromagnetic pollution is minimal. It's also CE tested.

SecuSignal

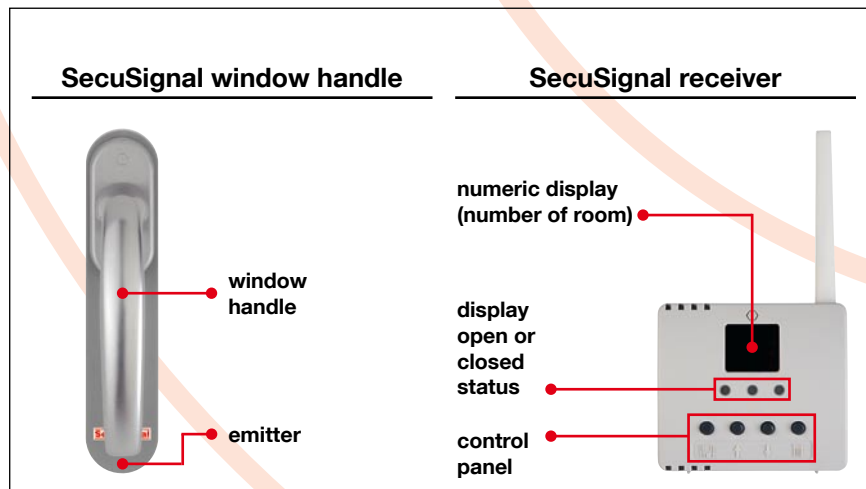

* technology from **EnOcean**



How does SecuSignal work?

Window is opened

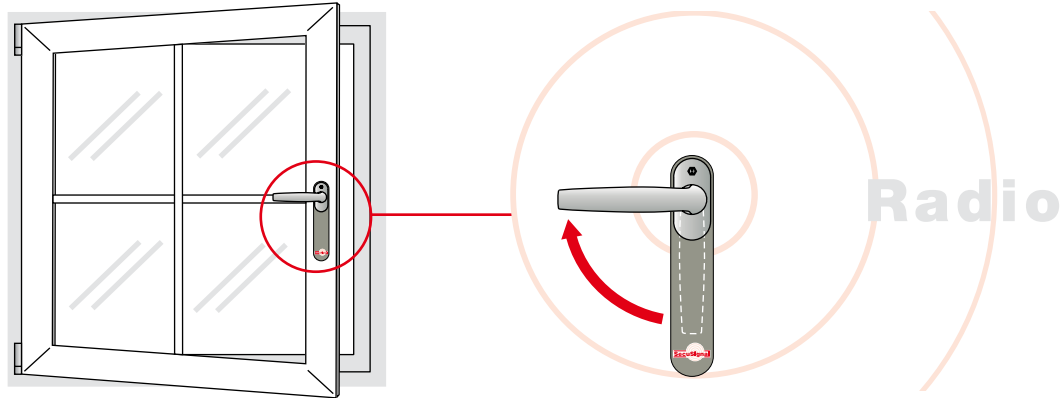

Window is tilted

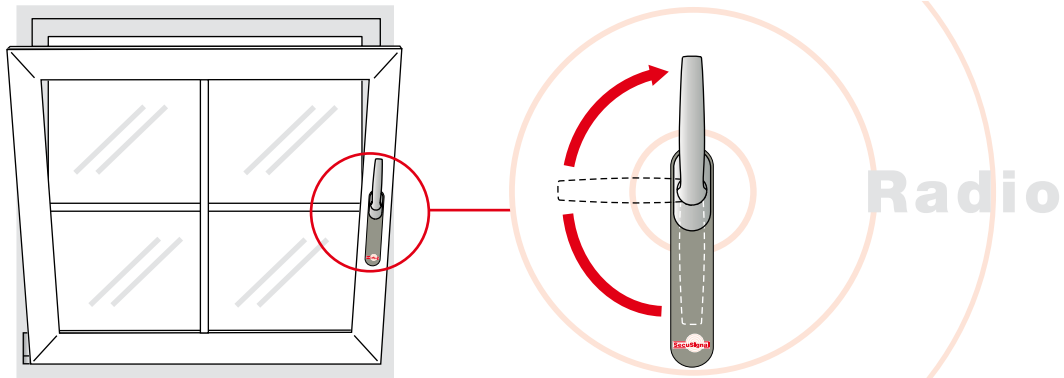

Window is closed

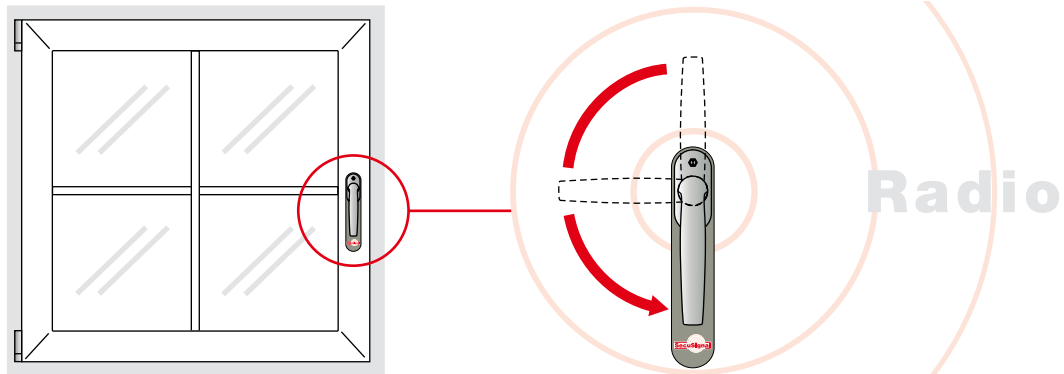

signal

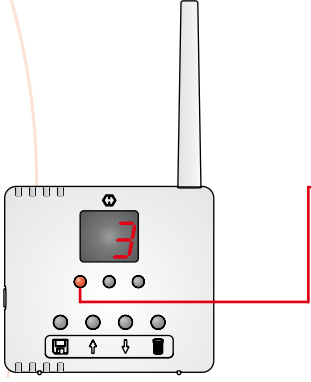
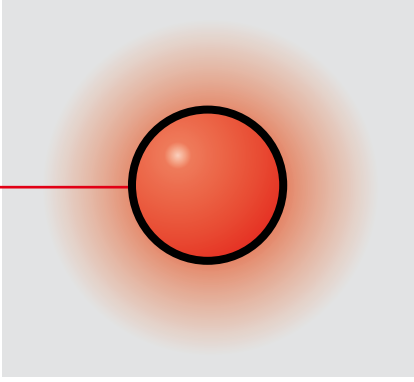
- The window handle is turned to the opening position
- The “open” signal is sent out to the receiver
- A **red** light shows on the receiver
- Caution: at least one window in room 3 is open!

signal

- The window handle is turned to the tilt position
- The “tilted” signal is sent out to the receiver
- A **yellow** light shows on the receiver
- At least one window in room 3 is tilted; is this OK?

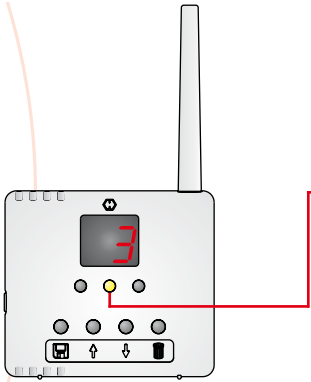
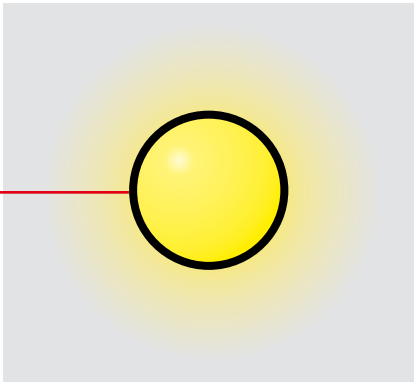
signal

- The window handle is turned to the closed position
- The “closed” signal is sent out to the receiver
- A **green** light shows on the receiver
- The window is closed – all's well!

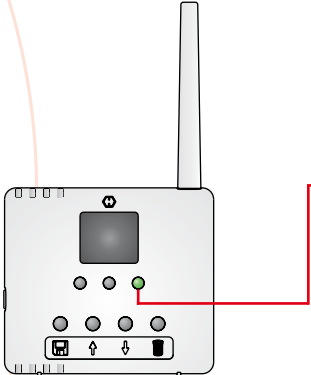
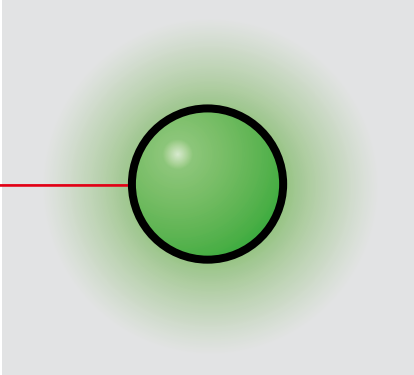
How does SecuSignal monitor all the windows in your house?

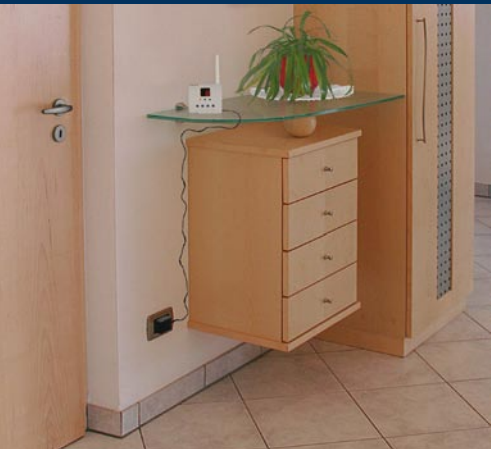

Up to 128 windows can be monitored

As a result of the radio technology without the need for batteries, SecuSignal can be easily and quickly be installed and is suitable for all standard windows*. You'll be able to check on whether a large number of windows handles in different rooms are in the open, tilted or closed position.

The receiver can deal with up to 128 SecuSignal radio emitters, a maximum 99 of which can be linked in freely programmable groups (eg all living room windows, bedroom windows etc.) and recognised by the receiver. On the two digit display you can then see at a glance where an open window might be a problem.

Example table for allocation and identification of rooms	
1	children's room 1
2	guest toilet
3	children's room 2
4	living room
5	kitchen/dining room
6	study
7	bathroom
8	guest room
9	bedroom
10	...



Two practical tips:

You can install your SecuSignal receiver in a fixed position or have it free-standing (220 v). It's best to have it in the hall, then you can check it as you leave.

The simplest way would be to allocate room numbers, from downstairs to upstairs according to importance eg 1. children's room, 2. bedroom, 3. living room.



The SecuSignal window handle sends out a radio signal saying "window handle in bedroom (9) open" to the central receiver.

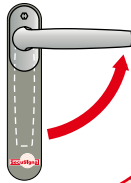

9 bedroom

6 study

5 kitchen/dining room

The receiver registers and stores the radio signal. The number of the room is shown on the display (in this case 9 for the group of windows in the bedroom) and the red light appears, warning you that a window in the bedroom is open.

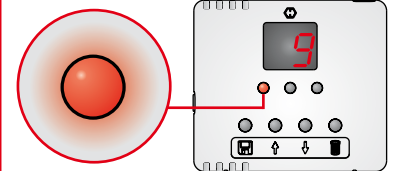

How does SecuSignal monitor all the windows in your house?

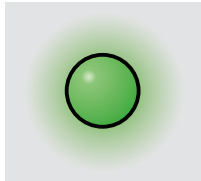
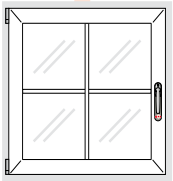
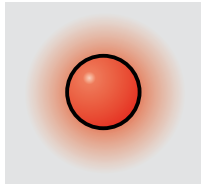
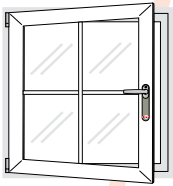

The most important things first

In normal operation, the SecuSignal receiver shows the window groups (rooms) in order according to potential danger.

- ① Window groups with SecuSignal window handles in open (●) as well as in tilted (●) position
- ② Window groups with SecuSignal window handles in open (●) position
- ③ Window groups with SecuSignal window handles in a tilt (●) position

For a quick and thorough check, the window groups shown change every two seconds. If the green light shows on the receiver, then all SecuSignal window handles are in the closed (●) position. You can still check the SecuSignal receiver manually by “leafing” through the window groups manually.

A practical example (see the chart on the opposite page):

- a) In window group bedroom (9) there are both open and tilted windows
- b) In window group living room (4) there are open windows
- c) In window group children's room 1 (1) and kitchen/ dining room (5) likewise, there are tilted windows

In intervals of two seconds, the SecuSignal receiver shows you firstly (9) the bedroom window group - with a red and yellow light, then (1) the children's room window group 1 - with a yellow light and finally the kitchen/dining room window (5) group (5) - equally with a yellow light. The display cycle then starts all over again.

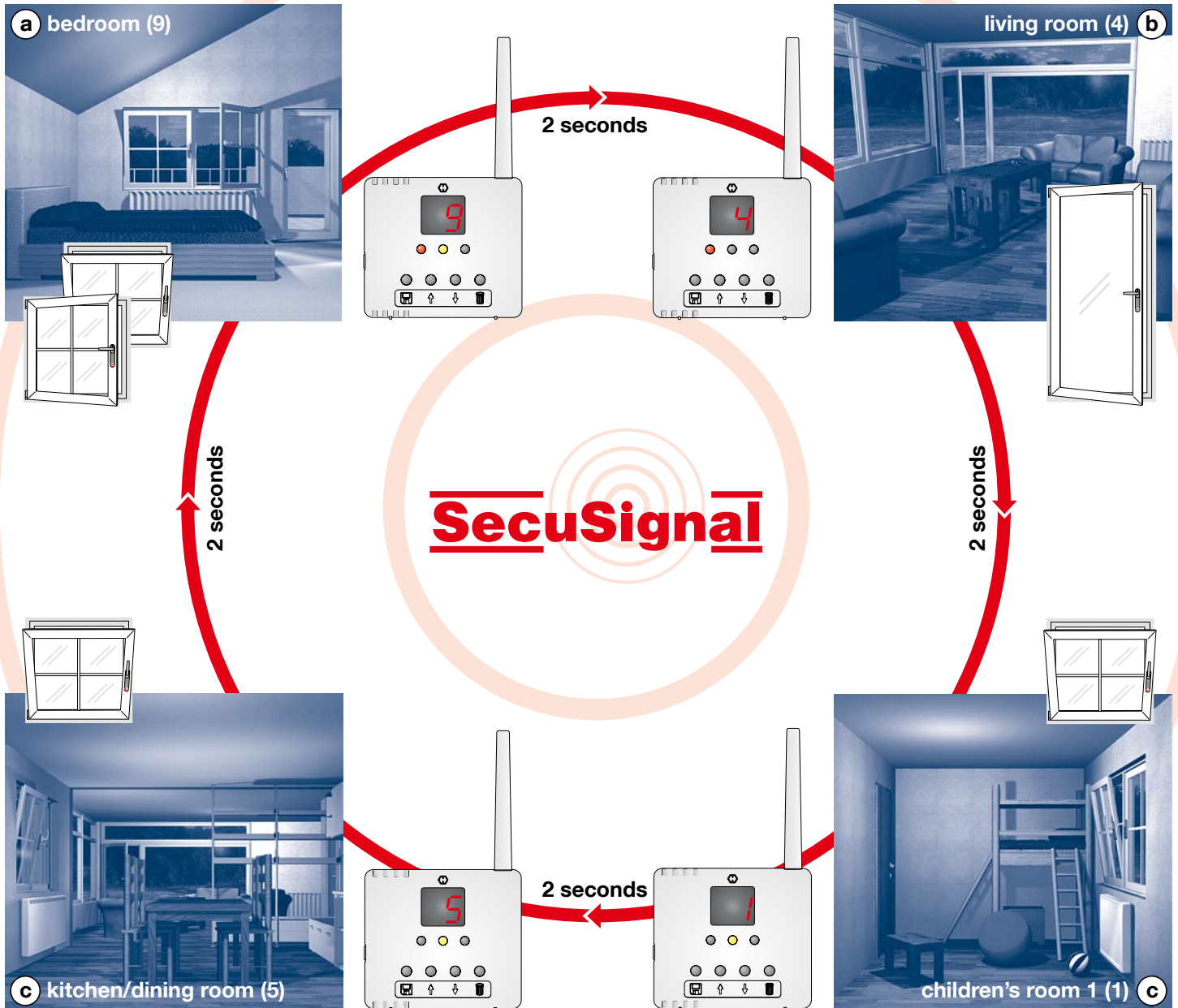

The SecuSignal range



What do I need to equip my house with SecuSignal?

All you need is

- a SecuSignal window handle on each window and an emitter
- a SecuSignal receiver

Example: If your house has 20 windows

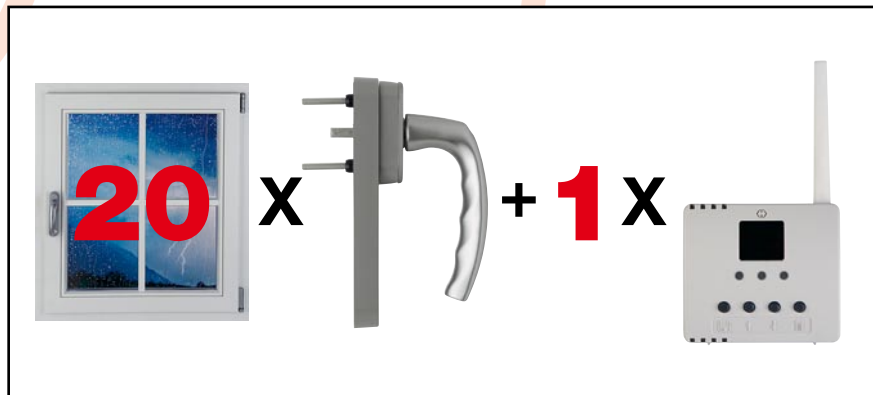

On the next page you can see the current SecuSignal range.

The finishing touch in attractive handle designs and materials

SecuSignal window handle designs with Secustik® technology*



Atlanta
0530/US952/FK-410
F9/F7501 (aluminium
steel/steel grey) finish



Atlanta
M0530/US956/FK-410
F71/F1509 (polished
brass/yellow gold) finish



Amsterdam
E0400/US956/FK-410
F69/F7501 (stainless
steel matt/steel grey)
finish

Secustik®

* All SecuSignal window handles have the latest HOPPE Secustik® technology! Secustik® window handles have a patented mechanical blocking mechanism as integrated basic security. This makes a precise clicking sound as the window handle is moved to different positions and helps prevent the window hardware being moved from outside. You can find further information on www.hoppe.com.

SecuSignal-receiver

FE-411
F7035 (light
grey) finish



SecuSignal

The advantages of SecuSignal at a glance



Easy, with assured transmittance and environmentally-considerate

- More comfort and safety through
 - central monitoring of the windows
- Based on radio technology, hence -
 - no complex wiring
 - suitable for all standard windows
 - quick and easy installation
- Very low energy signal transmission, hence -
 - high transmission assurance
 - minimal electromagnetic pollution
- No batteries required, hence -
 - totally maintenance-free
 - no worrying about spent batteries
 - no environmentally-harmful spent battery disposal



Just insert and watch ...

**The DVD film of the
new HOPPE generation**



Needed:

- DVD player or
- PC with DVD drive and software



Appointed Distributor:

HOPPE AG · Via Friedrich Hoppe · CH-7537 Müstair
 +41 (0)81 851 66 00 ·  www.hoppe.com
 +41 (0)81 851 66 66 ·  info.ch@hoppe.com