

ELECTRONIC THERMAL CONTROL SYSTEM FOR RADIATORS

STAND ALONE system



210 WiCal®

Stand-alone chrono-thermostatic control head, with backlit display. For thermostatic and convertible radiator valves. Touch button operation, integrated temperature sensor. Programmable directly, with displaying of temperatures and comfort-set back cycles. Battery electric supply: 2 x 1,5 V AA. Quick-coupling installation with adaptor. Protection class: IP 30.

NEW

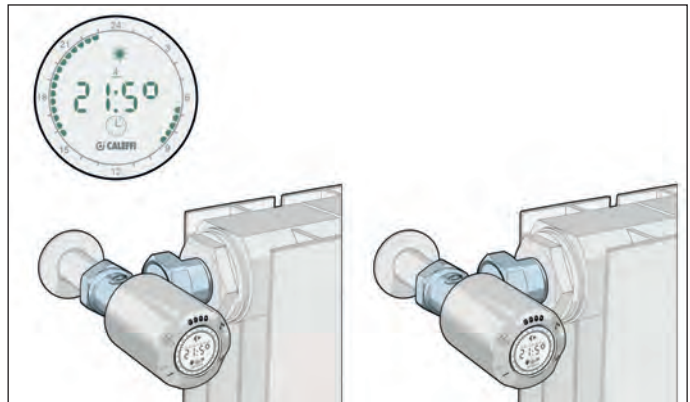

Code

210500



1

WIRELESS system



210 WiCal®

Electronic **wireless** control head. For thermostatic and convertible radiator valves. Touch button operation, integrated temperature sensor. Can be connected to multi-zone thermal controller code 210100. Radio communication RF 868MHz - Standard EnOcean EEP A5-04-01. Battery electric supply: 2 x 1,5 V AA. Quick-coupling installation with adaptor. Protection class: IP 30.

NEW

Operating principle

The **wireless** thermal control system comprises:

- multi-zone thermal controller
- electronic control head for radiator valve
- ambient temperature sensor (optional)

The thermal controller manages the temperature in different rooms by controlling the electronic actuators installed on the valves on each radiator.

The actual temperature is measured by the sensors in the room and/or integrated into the control head. Depending on the set temperature parameters and the comfort or set back cycles, the controller sends a modulating opening or closing signal to the actuators and an on/off signal to the boiler. The system is managed by radio wave signals.

The functional details include:

- easy and quick linking of wireless devices for rapid installation.
- Management of up to 8 temperature zones, which in turn are each able to control up to 4 actuators, thus with maximum system expansion of up to 32 actuators.
- easy individual time band programming for each zone, for every day of the week. Pre-set time band programmes and customisable programmes.

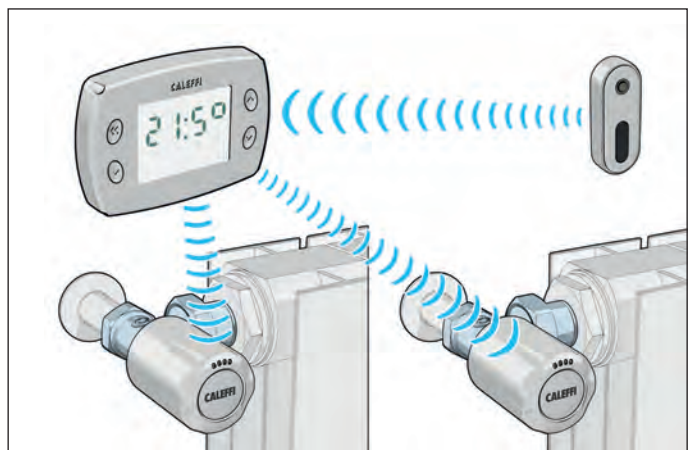

Code

210510



1



210 WiCal®

Wireless multi-zone thermal controller. For managing electronic control heads code 210510. Radio communication RF 868MHz - Standard EnOcean EEP A5-04-01. Transmission distance 30 m in closed rooms. Colour TFT graphic display. Touch button operation. Possibility to control the heat settings in up to 8 different zones. Weekly programmable clock. Auto - Holiday - Eco - Comfort functions. Electric supply: 24 V (dc). Auxiliary contact for heating request: 5 A. Protection class: IP 30.

Code

210100



1



210 WiCal®

Wireless ambient temperature sensor. For controlling the temperature in each zone or room. Radio communication RF 868MHz - Standard EnOcean EEP A5-04-01. Can be connected to multi-zone thermal controller 210 series. Electric supply: battery-less with photovoltaic cell. Protection class: IP 30.

Code

210001



1

Accessories

Code

- | | | | |
|---------------|--|---|---|
| 210011 | Wireless signal repeater with plug | 1 | - |
| 210010 | Wireless signal repeater with antenna | 1 | - |
| 210006 | Wireless interrupter remote control | 1 | - |
| 210004 | Power supply for regulation controller | 1 | - |

